

## **2 Way Power Splitter CSG 380050-2NW**

<b>PARAMETERS</b>	<b>SPECIFICATIONS</b>
Frequency Range	800 ~ 2500 MHz
Division Ratio	3.05 dB
Insertion Loss	≤ 3.5 dB
Isolation	≥ 20 dB
Impedance	50 Ω
VSWR	≤ 1.4 : 1
Power Rating	50 Watt
Connector	N(F)
Dimensions	117 x 83 x 21 mm
Weight (Approx.)	240 grams
Operating Humidity	5 % ~ 95 %
Operating Temperature	-30 °C ~ +60 °C



**WE ALSO UNDERTAKE DESIGNS PER YOUR REQUIREMENT**

## **3 Way Power Splitter CSG 380050-3NW**

<b>PARAMETERS</b>	<b>SPECIFICATIONS</b>
Frequency Range	800 ~ 2500 MHz
Division Ratio	4.83 dB
Insertion Loss	≤ 5.4 dB
Isolation	≥ 20 dB
Impedance	50 Ω
VSWR	≤ 1.4 : 1
Power Rating	50 Watt
Connector	N-Female
Dimensions	135 x 83 x 21 mm
Weight (Approx.)	245 grams
Operating Humidity	5 % ~ 95 %
Operating Temperature	-30 °C ~ +60 °C



**WE ALSO UNDERTAKE DESIGNS PER YOUR REQUIREMENT**

## 4 Way Power Splitter CSG 380050-4NW

PARAMETERS	SPECIFICATIONS
Frequency Range	800 ~ 2500 MHz
Division Ratio	6.02 dB
Insertion Loss	≤ 6.5 dB
Ripple in Band	≤ ±0.3 dB
Isolation	≥ 20 dB
Return Loss	≥ 20 dB
Amplitude Balance	≤ 0.2 dB
Phase Balance	≤ 5°
Impedance	50 Ω
PIM	≤ -140 @ +43 dBm x 2 dBc
Power Rating	50 Watt
Connector	N-Female
Dimensions	93 x 119 x 19 mm
Weight (Approx.)	486 grams
Operating Temperature	-30 °C ~ +70 °C

### Structure Drawing

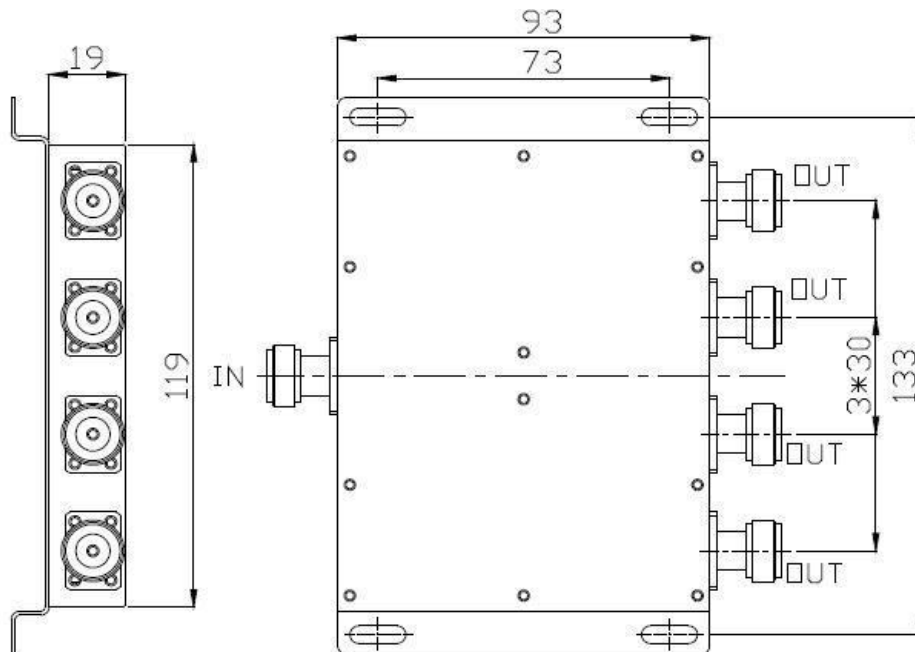

**WE ALSO UNDERTAKE DESIGNS PER YOUR REQUIREMENT**