

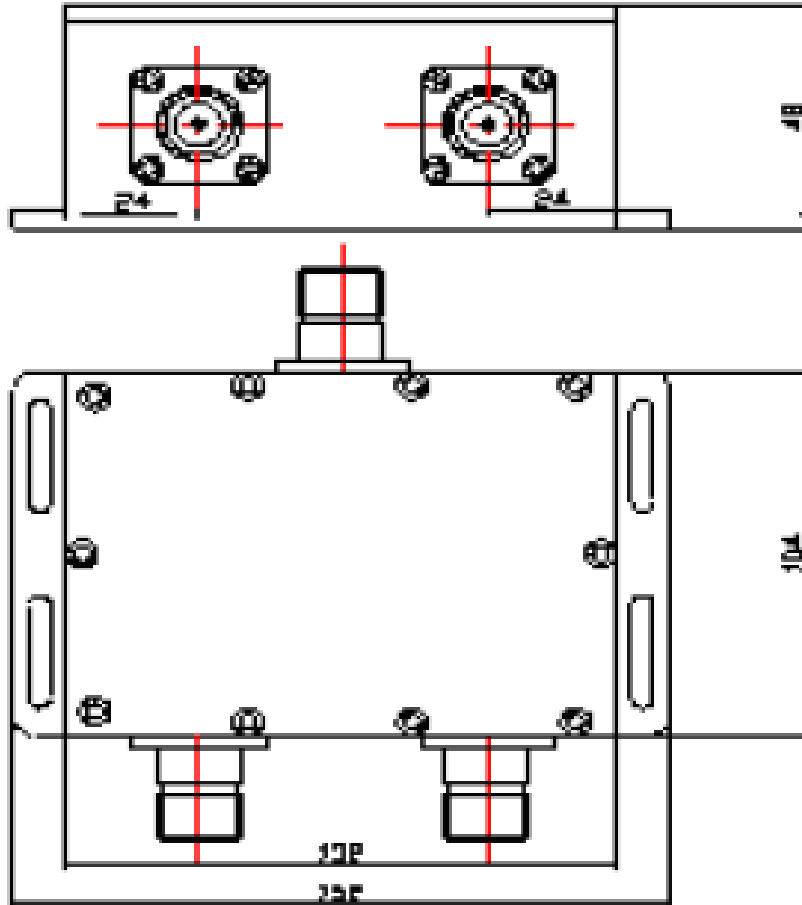

L Band Duplexer CSG 11600 LNX

PARAMETERS	SPECIFICATION	
Ports	Channel CH 1	Channel CH 2
Frequency Band	1520 ~ 1650 MHz	1621 ~ 1661 MHz
Band Width	40 MHz	40 MHz
Insertion Loss	≤ 1.0 dB	≤ 1.0 dB
Band Ripple	≤ 0.3 dB	≤ 0.3 dB
Return loss	≥ 18	≥ 18
Isolation	≥ 90 dB @ CH 2	≥ 90 dB @ CH 1
Power	≤ 100 Watt	
Impedance	50 Ω	
Connectors	N-Female	
Temperature	-25 ~ + 60 °C	
Operating Humidity	5 ~ 95 %	
Color	Black or Silver grey	
Dimension (Approx)	48 × 132 × 104 mm	
Weight	800 grams	
Environmental	IP 65	

Structure Drawing:



WE ALSO UNDERTAKE DESIGNS PER YOUR REQUIREMENT