

## 3 Way Power Splitter CSG33050-3NWX

PARAMETERS	SPECIFICATIONS
Frequency Range	300 - 500 MHz
Insertion Loss	$\leq 5.2\text{dB}$
Isolation	$\geq 20\text{ dB}$
Impedance	$50\ \Omega$
VSWR	$\leq 1.25:1$
Power Rating	50 Watt
Connectors	N-Female
Weight (Approx.)	330 grams
Dimensions (Approx.)	94.5 x 77 x 22.3 mm
Housing Material	Aluminum
Operating Temperature	-20 °C to +60 °C

### Mechanical Drawing

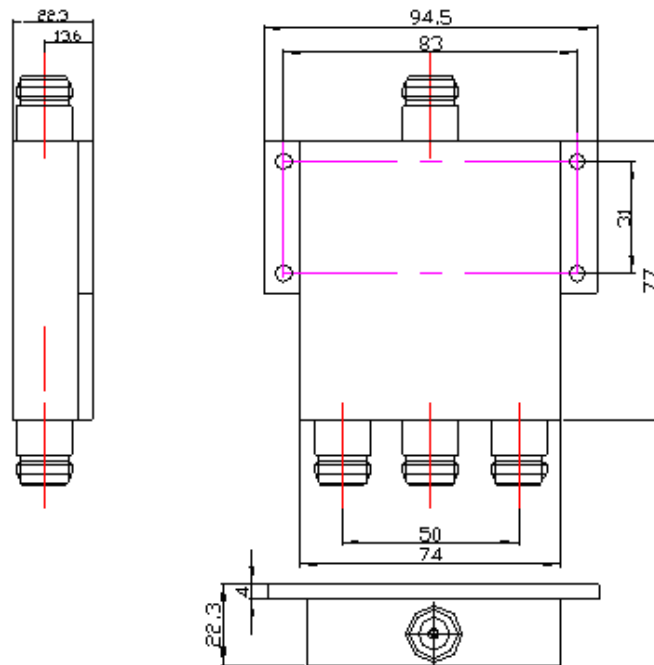

## Front View

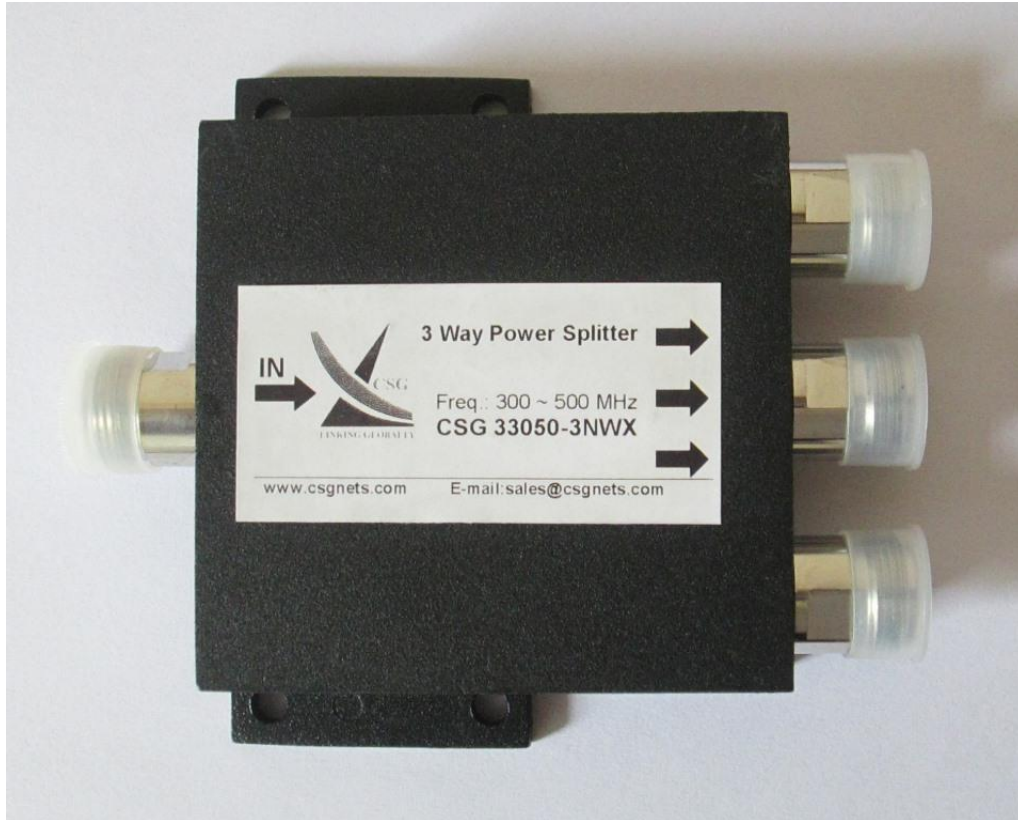

**WE ALSO UNDERTAKE DESIGNS PER YOUR REQUIREMENT**