



Wide Band 2IN 2OUT 3dB Hybrid Coupler

CSG 38002500-200N

PARAMETERS	SPECIFICATIONS
Frequency range	800 ~ 2500 MHz
Dissipation Loss	≤ 3.01 dB
Insertion Loss	≤ 0.50 dB
Band Ripple	≤ 0.50 dB
Coupling	3.0 ± 0.50 dB
Isolation	≥ 22 dB
VSWR	≤ 1.20
Power	≥ 200 Watt
Impedance	50 Ω
Connectors	N-Female
Dimensions (Approx.)	111.2 x 32.2 x 18 mm
Weight (Approx.)	240 grams
Operating Humidity	5 ~ 95 %
Operating Temperature	-30 ~ 70 °C

Structure Dimensions:

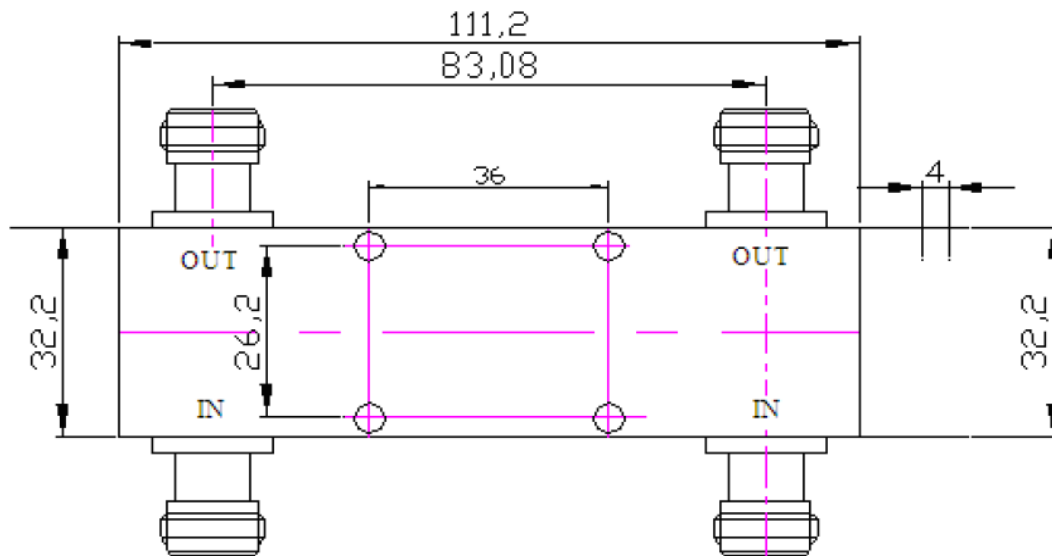

WE ALSO UNDERTAKE DESIGNS PER YOUR REQUIREMENT